

Zip Screen radio motor

Adjustment instructions lower end position for ZIVO and Perfect ZIP

Maestria IO

Teaching in a radio transmitter that has not been pre-taught

1. Schalten Switch off the power supply (the pre-taught radio transmitter is deleted)
2. Switch on the power supply again.
The curtain confirms with a short up/down movement.
3. Simultaneously press the UP and DOWN buttons of the radio transmitter to be taught in.
transmitter until the blind is activated with a short up/down movement.
4. Press the PROG button on this radio transmitter.
The blind confirms with a short up/down movement.
The radio transmitter has been preset.

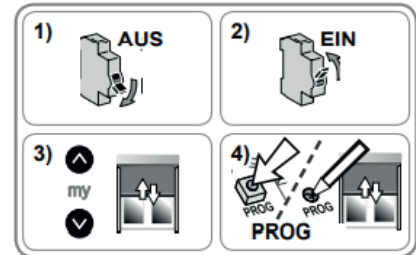

The UPPER FINAL LEVEL is adjusted AUTOMATICALLY; the adjustment of the LOWER FINAL LEVEL must be done MANUALLY.

Setting the lower end position

1. switch on the power supply
2. Press the UP and DOWN buttons simultaneously for the channel/hand-held transmitter to be taught in, the hand-held transmitter is pre-taught.
3. drive the hanging halfway.
4. Move the blind to the lower end position and adjust the position with the MY button if necessary.
5. When the lower end position is correct, press the UP and MY buttons simultaneously, the blind confirms with a short stop.
6. The blind then automatically moves to the upper end position.
7. Press and hold the MY button to save the end positions.
8. the programming button to program the hand-held transmitter.

